

NOTES

1. Use posted speed limit or 85th percentile speed whichever is higher.
2. Sight distance is based on a measurement from an eye height of 115 cm to an object height of 115 cm.
3. Mark a no-passing zone when the sight distance for the speed on the curve (measured in the field) is less than minimum sight distance listed in this Table 1.
4. Also see S-2013-312 Highway Signage and Pavement Markings - Railway Crossings

TABLE 1
NO-PASSING ZONE REQUIREMENT
FOR VERTICAL
OR HORIZONTAL CURVES

SPEED LIMIT (km/h) <small>SEE NOTE 1</small>	MINIMUM SIGHT DISTANCE (m) <small>SEE NOTES 2 AND 3</small>
50	160
60	200
70	240
80	275
90	330
100	400
110	475
120	565

TABLE 2
SOLID LINE LENGTH ON
APPROACHES TO INTERSECTIONS
AND RAILWAY CROSSINGS

SPEED LIMIT (km/h) <small>SEE NOTE 1</small>	SOLID LINE LENGTH (m)
50	80
60	100
70	120
80	140
90	165
100	200
110	240
120	285

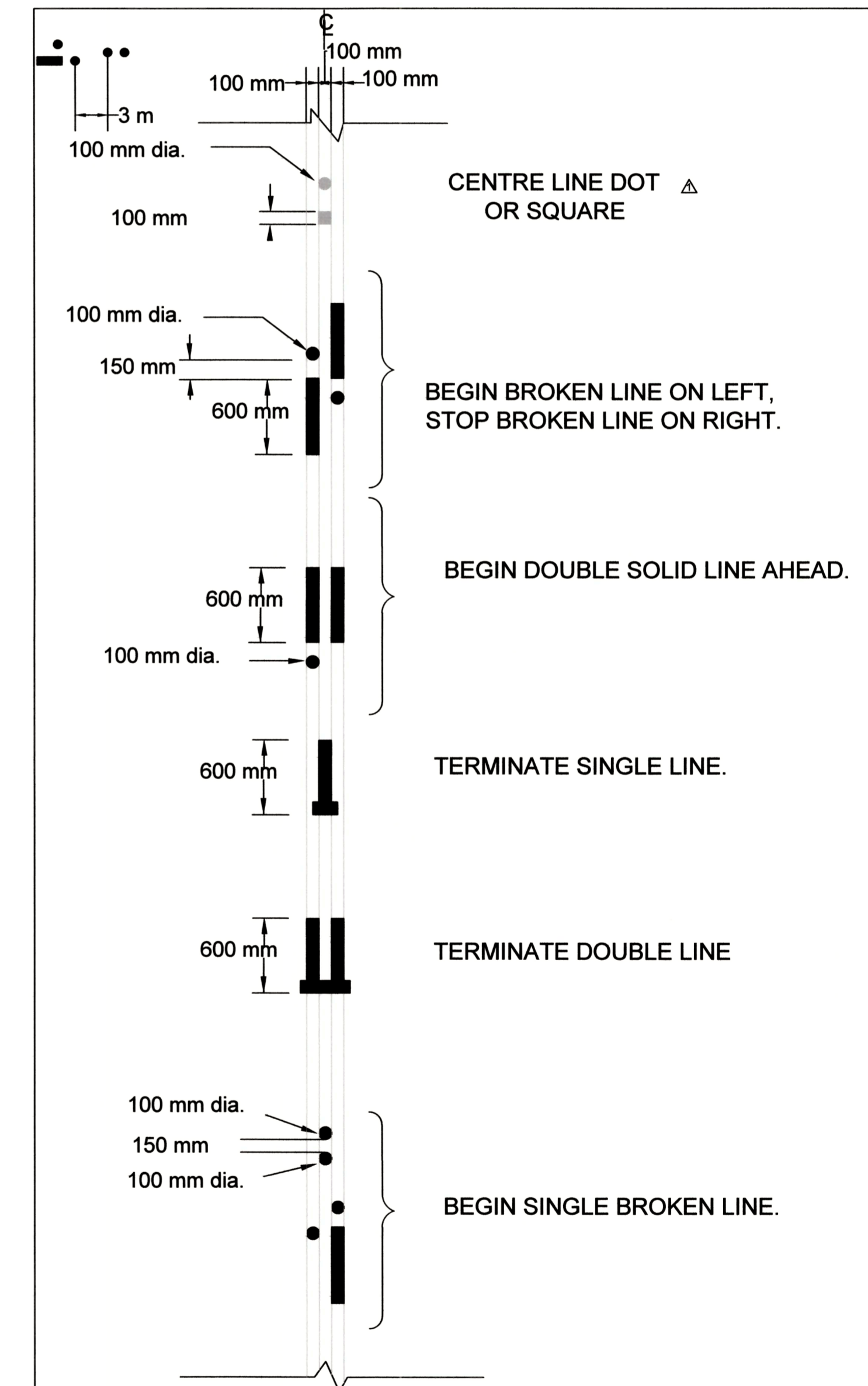
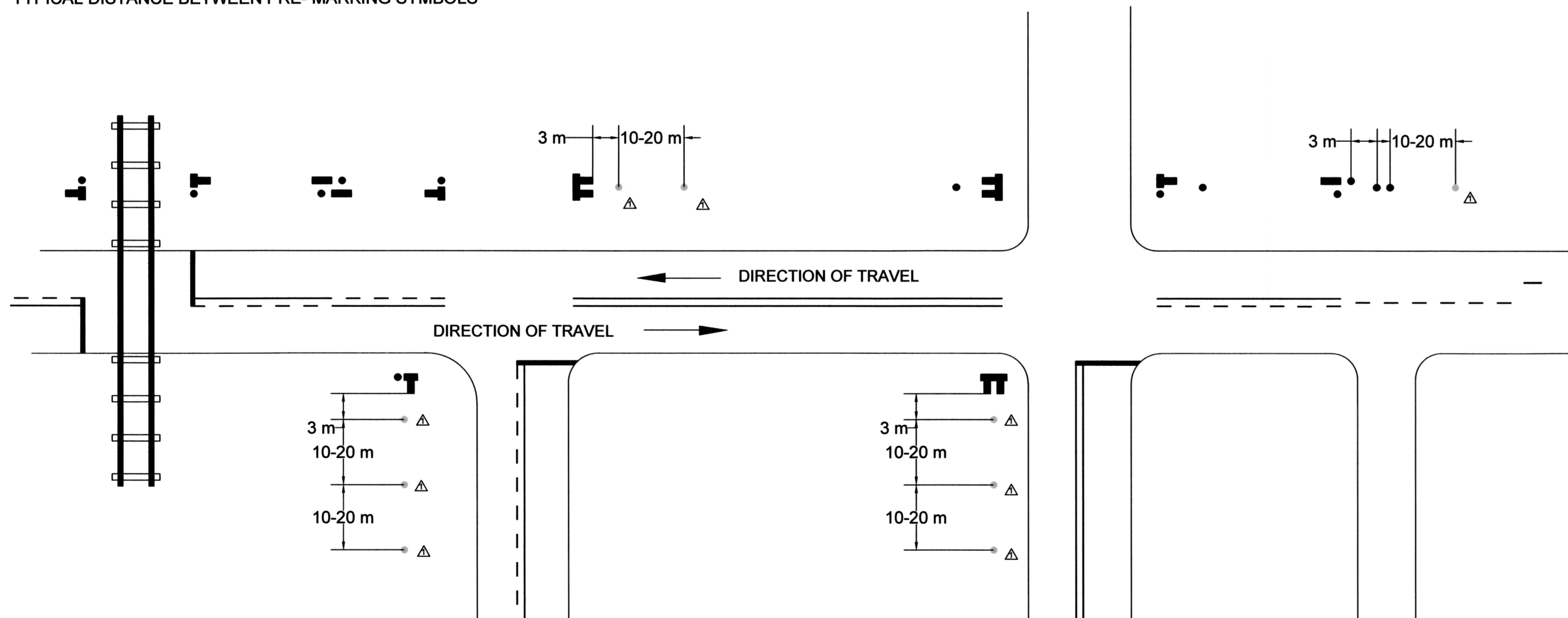
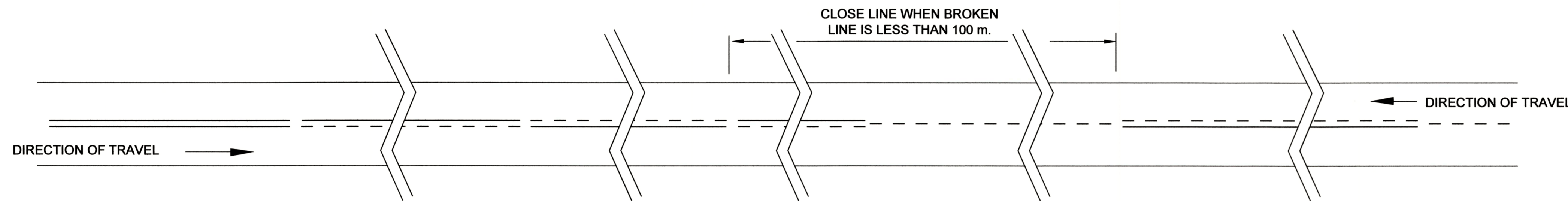

LEGEND FOR PRE-MARKING SYMBOLS

Designed by:
 Surveyed by:
 Drawn by: R.Hird
 Checked by:
 Approved by:

Mika Pitt
 Manager Traffic Engineering Services
 Apr 9/14
 Date

Brian D...
 Director, Highway Engineering Services
 9/4/14
 Date

MK.	DATE	REVISION
1	April 2014	Centreline dot colour changed, Notes and tables added.



Scale: NTS
 Date: Dec. 2013
 File No.: S-2013-308
 Sheet No.: 1 of 1

HIGHWAY PAVEMENT MARKINGS

PRE-MARKING